



**CONEJO VALLEY UNIFIED SCHOOL DISTRICT**  
**Student Support Services**  
 1400 E. Janss Rd., Thousand Oaks CA 91362  
 (805) 497-9511

**Individualized Healthcare Plan (IHP)**  
**ALLERGY & ANAPHYLAXIS**

<b>Pupil:</b>			
<b>Grade:</b>	<b>DOB:</b>	<b>Educational Placement:</b>	
<b>School:</b>			
<b>District:</b>			
<b>School Nurse:</b>		<b>Cell #</b>	
<b>Parent/Guardian Consent Date:</b>		<b>Physician Authorization Date:</b>	
<b>Parent Signature:</b>			
<b>Mother</b>	<b>Primary Phone #</b>		<b>Secondary Phone #</b>
<b>Father</b>	<b>Primary Phone #</b>		<b>Secondary Phone #</b>
<b>Guardian</b>	<b>Primary Phone #</b>		<b>Secondary Phone #</b>
<b>Home Address</b>		<b>City</b>	<b>Zip</b>
<b>Other Contact (Relationship):</b>		<b>Primary Phone #</b>	<b>Secondary Phone #</b>
<b>Physician</b>		<b>Phone #</b>	<b>Fax #</b>
<b>Physician Address</b>		<b>City</b>	<b>Zip</b>
<b>Healthcare Service Needed at School</b>	<b>Management of Allergy &amp; Anaphylaxis at School and School Sponsored Events:</b>		
<b>Purpose of an IHP</b>	<ol style="list-style-type: none"> <li>1. <b>The purpose</b> of an Individualized Healthcare Plan (IHP) is to provide safe management of healthcare needs and services for pupils at school and during school-related activities.</li> <li>2. <b>The school nurse</b>, in collaboration with the student and the student's parent/guardian, healthcare providers, and school team, is responsible for:             <ol style="list-style-type: none"> <li>a) Development, implementation, and revisions of the IHP.</li> <li>b) The training and supervision of all designated personnel who will provide healthcare according to the ISHP and standard procedures.</li> </ol> </li> <li>3. <b>IHP revisions</b>, If and when revisions are needed to the IHP, parent/guardian will inform school nurse of any updates from the physician by providing a doctor's note.</li> <li>4. <b>IHP review</b> must occur annually and whenever necessary to ensure provision of safe care.</li> </ol>		

PLACE  
PICTURE  
HERE

Pupil: \_\_\_\_\_ DOB: \_\_\_\_\_

NOTE: Do not depend on antihistamines or inhalers (bronchodilators) to treat a severe reaction. USE EPINEPHRINE.

Extremely reactive to the following allergens: \_\_\_\_\_

THEREFORE:

- If checked, give epinephrine immediately if the allergen was LIKELY eaten, for ANY symptoms.
- If checked, give epinephrine immediately if the allergen was DEFINITELY eaten, even if no symptoms are apparent.

FOR ANY OF THE FOLLOWING:  
**SEVERE SYMPTOMS**



**LUNG**

Shortness of breath, wheezing, repetitive cough



**HEART**

Pale or bluish skin, faintness, weak pulse, dizziness



**THROAT**

Tight or hoarse throat, trouble breathing or swallowing



**MOUTH**

Significant swelling of the tongue or lips



**SKIN**

Many hives over body, widespread redness



**GUT**

Repetitive vomiting, severe diarrhea



**OTHER**

Feeling something bad is about to happen, anxiety, confusion

OR A  
COMBINATION  
of symptoms  
from different  
body areas.

**INJECT EPINEPHRINE IMMEDIATELY.**

1. **Call 911.** Tell emergency dispatcher the person is having anaphylaxis and may need epinephrine when emergency responders arrive.
  - Consider giving additional medications following epinephrine:
    - » Antihistamine
    - » Inhaler (bronchodilator) if wheezing
  - Lay the person flat, raise legs and keep warm. If breathing is difficult or they are vomiting, let them sit up or lie on their side.
  - If symptoms do not improve, or symptoms return, more doses of epinephrine can be given about 5 minutes or more after the last dose.
  - Alert emergency contacts.
  - Transport patient to ER, even if symptoms resolve. Patient should remain in ER for at least 4 hours because symptoms may return.

**MILD SYMPTOMS**



**NOSE**

Itchy or runny nose, sneezing



**MOUTH**

Itchy mouth



**SKIN**

A few hives, mild itch



**GUT**

Mild nausea or discomfort

FOR MILD SYMPTOMS FROM MORE THAN ONE SYSTEM AREA, GIVE EPINEPHRINE.

FOR MILD SYMPTOMS FROM A SINGLE SYSTEM AREA, FOLLOW THE DIRECTIONS BELOW:

1. Antihistamines may be given, if ordered by a healthcare provider.
2. Stay with the person; alert emergency contacts.
3. Watch closely for changes. If symptoms worsen, give epinephrine.

**MEDICATIONS/DOSES**

Epinephrine Brand or Generic: \_\_\_\_\_

Epinephrine Dose:  0.15 mg IM  0.3 mg IM

Antihistamine Brand or Generic: \_\_\_\_\_

Antihistamine Dose: \_\_\_\_\_

Other (e.g., inhaler-bronchodilator if wheezing): \_\_\_\_\_

PATIENT OR PARENT/GUARDIAN AUTHORIZATION SIGNATURE

DATE

PHYSICIAN/HCP AUTHORIZATION SIGNATURE

DATE

## ALLERGY & ANAPHYLAXIS EMERGENCY CARE

Treat the person before calling emergency contacts. The first signs of a reaction can be mild, but symptoms can worsen quickly.

### HOW TO USE AUVI-Q® (EPINEPHRINE INJECTION, USP), KALEO

1. Remove Auvi-Q from the outer case.
2. Pull off red safety guard.
3. Place black end of Auvi-Q against the middle of the outer thigh.
4. Press firmly, and hold in place for 5 seconds.
5. Call 911 and get emergency medical help right away.

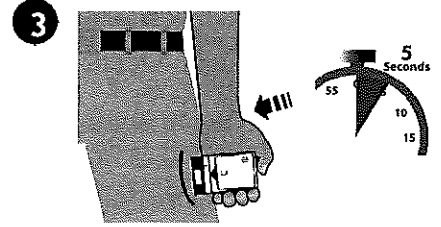

### HOW TO USE EPIPEN® AND EPIPEN JR® (EPINEPHRINE) AUTO-INJECTOR, MYLAN

1. Remove the EpiPen® or EpiPen Jr® Auto-Injector from the clear carrier tube.
2. Grasp the auto-injector in your fist with the orange tip (needle end) pointing downward.
3. With your other hand, remove the blue safety release by pulling straight up.
4. Swing and push the auto-injector firmly into the middle of the outer thigh until it 'clicks'.
5. Hold firmly in place for 3 seconds (count slowly 1, 2, 3).
6. Remove and massage the injection area for 10 seconds.
7. Call 911 and get emergency medical help right away.

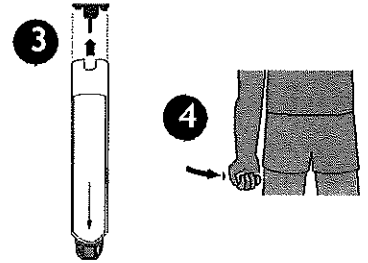

### HOW TO USE EPINEPHRINE INJECTION (AUTHORIZED GENERIC OF EPIPEN®), USP AUTO-INJECTOR, MYLAN

1. Remove the epinephrine auto-injector from the clear carrier tube.
2. Grasp the auto-injector in your fist with the orange tip (needle end) pointing downward.
3. With your other hand, remove the blue safety release by pulling straight up.
4. Swing and push the auto-injector firmly into the middle of the outer thigh until it 'clicks'.
5. Hold firmly in place for 3 seconds (count slowly 1, 2, 3).
6. Remove and massage the injection area for 10 seconds.
7. Call 911 and get emergency medical help right away.

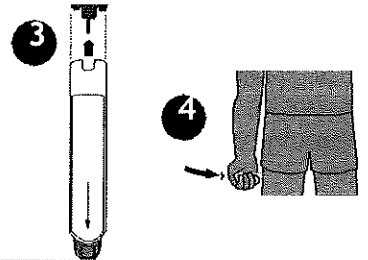

### HOW TO USE IMPAX EPINEPHRINE INJECTION (AUTHORIZED GENERIC OF ADRENALCLICK®), USP AUTO-INJECTOR, IMPAX LABORATORIES

1. Remove epinephrine auto-injector from its protective carrying case.
2. Pull off both blue end caps: you will now see a red tip.
3. Grasp the auto-injector in your fist with the red tip pointing downward.
4. Put the red tip against the middle of the outer thigh at a 90-degree angle, perpendicular to the thigh.
5. Press down hard and hold firmly against the thigh for approximately 10 seconds.
6. Remove and massage the area for 10 seconds.
7. Call 911 and get emergency medical help right away.

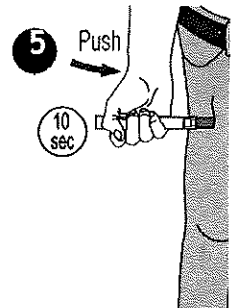

### ADMINISTRATION AND SAFETY INFORMATION FOR ALL AUTO-INJECTORS:

1. Do not put your thumb, fingers or hand over the tip of the auto-injector or inject into any body part other than mid-outer thigh. In case of accidental injection, go immediately to the nearest emergency room.
2. If administering to a young child, hold their leg firmly in place before and during injection to prevent injuries.
3. Epinephrine can be injected through clothing if needed.
4. Call 911 immediately after injection.

**OTHER DIRECTIONS/INFORMATION** (may self-carry epinephrine, may self-administer epinephrine, etc.):